



**Ideas to Improve Your Luck Now!**

# 26 Secrets

**F R O M   T H E   O R I E N T**

MAKE MORE MONEY,  
IMPROVE YOUR HEALTH,  
FIND LOVE!

**FENG SHUI**  
By Eloise Helm

坤



Aquarian Publications  
P.O. BOX 681  
Palm Springs, California 92263  
© 2002 Eloise Helm

All rights reserved. No part of this book may be reproduced in any form or by any means, electronic or mechanical, including photocopying, recording or by any information storage and retrieval system, without permission in writing from the publisher.

*First Edition*

Illustrations by C.J. Correnti / C2 Media Group, Inc.  
© 2002 C2 Media Group, Inc.

Library of Congress Cataloging-in-Publication Data  
ISBN 0-9639204-7-2



# Introduction

**A**lthough Feng has been practiced in the Eastern hemisphere for thousands of years, it is relatively new to western civilization. Feng Shui may seem mysterious and foreign to our western culture, but it is actually a very sensible collection of ideas and actions. Once you understand its principles, you will be able to produce harmony, comfort and balance in almost any situation or environment.

26 Secrets has been put together to simplify Feng Shui so that everyone can understand and work with its principles to balance their lives and make way for more money, love, health and happiness. Some of these tips will help bring these things to you, while others will make it easier to hold on to money, romance and health once they're in your hands. When you energize the various parts of your home, your life will improve and you will start to attract more abundance and happiness.

Begin to think of balance in all things. For example, you must activate your career and benefactor sections so that you can be a magnet for exposure to opportunities and people who will help you get ahead. It will be easier for you to invite wealth when you have a happy love life. And if you are loved, you are more likely to stay healthy and attain the kind of wealth that stays with you.

Before you begin, critically evaluate all areas of your home, examining each and every room inside as well as outside of the house.

Knowing your Kua number will help you better understand your element, your best colors and your best directions for improving your life. These are all tools to help you attain your goals.

26 SECRETS will help you decorate your home to improve your health, increase your wealth and find overall harmony. The "secrets" herein is just a glimpse of what you can do to improve your life.

If you've heard about Feng Shui and are intrigued, we think this little book will help you get started with the greatest of ease.

Love and best wishes for success,

Eloise Helm

# DEFINING CHI ENERGY

**SHENG CHI** - According to the ancient Chinese theory about the universe, there are several different sources of energy that move in and around us. Sheng Chi energy is the good healthy, prosperous, happy energy. You have Sheng Chi when you are positive and all good things are flowing your way. You can feel when there is good Sheng Chi energy in a place. You feel as though you could stay there forever. It is light and airy. When you live an uncluttered life with fresh flowers, lush green plants, bright cheerful sunshine flowing in your place you know you are in good Sheng Chi energy.

**SHA CHI** - When everything in your life is going in the wrong direction or you feel unhappy and angry, you are in Sha Chi energy. You may be associating with the wrong people, living in the wrong place or connecting to poison arrows coming in your direction. This type of energy drains you and causes you to become ill. Living on land with underground water also causes Sha energy. Poison arrows are the corners of other buildings pointing at your front door or pointing in your direction where you work all day. It is a place where the earth is depleted and the vegetation is poor, where animals are sick and people are impoverished. You have Sha Chi when you are down and depressed.



# Your Front Door Should Encourage Good Ch'i

An attractive entrance to your home or office will encourage good ch'i, or energy, to enter. If you can arrange your front door so that it faces your overall harmony or great prosperity direction, it will help bring in wealth, love and happiness. As all energy enters through your front door, it is important to keep things away from the door so the door will be free to open without problems.

Make sure your front door is not broken, and opens smoothly. A broken door or one that is hard to enter is the worst kind of energy to start with. Your door size should not be too large or too small relative to the size of the house. If the western world had practiced feng shui from the beginning, we could have avoided much of the trouble we have today in our personal lives as well as in our work or business.

I have seen many front doors of homes face a solid wall immediately upon entering. The main door should not open inside onto a solid wall within three feet of the open door. The only thing you can do is to place a mirror here so that upon entering, the space looks larger. This is not an ideal solution, as it is not good to have a mirror reflecting the front door, but it is better to have a mirror here if the space is too tight for comfort.



The subject of Feng Shui is actually far more profound than the popular belief that it is a kind of mystic interior design. It is the art and science of living and working in the right environment.

Feng Shui is concerned with the flow and circulation of vital energy called "Chi" and is the interplay of the Yin and Yang within the five elements. Feng Shui is the intertwining between people, places and the interactions of energies. The universe is a vast field of energy. Feng Shui is the study of this energy and how it moves through the universe and affects us directly and indirectly. Modern science of Electrophysics is beginning to realize the interaction of electromagnetic energies between the earth and humans. These electromagnetic energies are the Chi lines running through the veins of the earth, thus creating energy for the earth and the people who live upon it.

The size of the door should be well balanced to the dwelling, not too small or oversized in proportion to the rest of the house. Too narrow an entrance stifles the flow of good ch'i entering the house, and you will have to invest more time, money and energy to achieve your goals if you live in a house with a small entrance.

Well-situated front doors are wide and lead into a foyer that open to other rooms in the house. The foyer acts as a buffer to slow the fast flowing energy as it enters your home. The front door should never open directly into the living room without some kind of buffer to slow the energy. If you have no choice put an attractive three-fold screen a few feet from the entrance with a healthy green plant in front of the screen. The screen slows the good ch'i energy so that it can flow softly around the screen.



The first things you or visitors see when entering your home set the mood for the rest of the stay. Clutter should not be allowed to accumulate anywhere, but the entrance is a particularly bad place for untidiness. People have a tendency to put things at the door as a reminder to get rid of the things with good intentions of taking them away. But have you noticed even with yourself you leave it there, because you are in a hurry and will do that later. Later, turns into days later. This is bad for the subconscious mind. It is there when you arrive back home and due to the rush it continues to stay there. If you want good feng shui in the home taking this stuff away should be first on your priority list

When you look out of your front door, you should not face a hill, and the door itself should not be hidden by shrubbery. It is not a good situation if there are obstructions in front of the door, such as a steep hill, another larger building, or any kind of over-sized or massive structure.

The entrance should be well lit and airy. The best shape for a door is oval or square at the top. Solid wood doors are better than glass doors. The entrance should not have sharp angles from other buildings pointing toward the door. You can place a mirrored PaKua to deflect some of the negative energy from entering your home.



You can also hang wood or metal wind chimes to help deflect the energy. Remember, the chimes must be hollow to be effective and the PaKua must be placed on the outside of the house. It is unlucky to have a mirrored PaKua inside of your home.

Bright-colored doors are very inviting and set the tone for overall harmony inside the home. Regardless of the color you select, it should provide a good contrast to the color of the rest of the house. Red is a good color for a door, but only if it is a compatible color for your

overall harmony or great prosperity. The color should also be compatible with the main colors of the house.

Red can be used if you are an East, South or Southwest person. Green or blue is an excellent color if you are an East person. Gold is beneficial and a good color for the door if you are a west person. All colors bring in good ch'i energy and are attractive to any entrance. Colors are explained later in the book.

In Feng Shui, people as well as homes are divided into EAST and WEST groups. You can determine if your house is good for you once you establish whether you are an East or West group person. If you live in the type of house appropriate for the opposite group, you may never become wealthy in that house. However, you can arrange the furniture to improve your living conditions. There are four good directions and four bad directions for each group. If you are an East person, the four west directions are bad and if you are a West person, the four east directions are bad for you.

If you are an EAST person, your good directions are North, East, Southeast and South. If you are WEST, your best directions are West, Northwest, Northeast and Southwest.

Once you decide which group you belong in, you can sometimes change the direction of the house by entering through a different door that faces one of your four good directions.

Beautiful, colorful flowers and lush green shrubbery also bring a sense of harmo-

ny and are important enhancements to an entrance. While many sidewalks lead in a straight line toward the door, it is more beneficial if the walk curves or meanders toward the door. If your walkway leads in a straight line to your door you should try to change it to one that curves or one that leads to the side to disburse the straight racing energy that flows toward the door.

Wind chimes are good instruments for beneficial energy when placed next to the front and back doors. The chimes should be hollow and large enough so they produce a nice melody of pleasing sounds when chimed. Together with harmony and rhythm, melody is one of the three basic elements of music. Having soothing sounds in your environment is another way to attract harmony and money.

Speaking of sound, soft music in the home is important to elevate one's energy, making it easier to produce good work that generates more money.

The front door entrance should never lead in a straight line to a back door or large window. All of your luck and finances will flow through the house and out the back door or window. This is the worst kind of energy of all for losing your hard earned money. If you have this problem fix it immediately. If you live in a place with this problem, you can place a large screen at a distance from the front door so that it covers the view to the back door, and place a large plant in front of the screen.

Nowadays, many people live in city high-rises. Apartment and condominium living provide different challenges. If you live in an apartment building, never live at the end of a long corridor, nor in front of the elevator or stairway. All of your finances will fly away and down through the fast moving energy of the stairway, elevator or long corridor. If possible, place a plant at the entrance in the hallway to slow some of the fast flowing energy.

If you live in an apartment building, green plants and fresh flowers can be used to bring nature into your home. Fresh flowers brought in weekly help keep your energy level high.





## Balance Your Living Room

As mentioned earlier, the ideal entrance to your living room should open from a foyer. When the front door opens directly into the living room, a buffer is needed to slow down the fast flowing energy from the entrance to your home.



You should choose colors for your living room that are beneficial to your Kua number and direction or that suit your overall harmony. I recently did a Feng Shui for a lady who was a West person that had a green sofa and love seat in her home. If she would have read this book or consulted with me before buying the sofa she would have known that green is the worst color for her to use. Her whole living room was green. She immediately went out and bought gold covers and saw an improvement with her life soon after. Her business improved tremendously.

Place green plants around the room, but balance them with other things. Your furniture should be spacious, uncluttered and pleasing to the eye. Paintings should be warm and inviting. Never have cactus in your home. Cactus is the worst kind of plant you can have in your home. They are very unlucky. Try to keep a nice bouquet of fresh flowers near the entrance to the house. People feel immediately at ease when they see fresh flowers. This is the reason you always see fresh flowers in restaurants or in the lobbies of hotels.

Your living room should be fresh and have a feeling of being lived in. So many families have family rooms they use instead of their living rooms, saving the living room for special occasions. Rooms in your home that are unused accumulate stagnant energy and detract from an otherwise balanced home.

### **Live in this room! That's how it got its name!**

Fireplaces, regardless of the room where they are found, should never be left uncovered. A screen or glass should cover the opening. Open fireplaces leak out good ch'i energy and take away all of your money.



## Make Sure Your Bedroom is a Safe Haven

Your bedroom has an effect on the way you sleep, and this is a very important factor in staying healthy, happy and accumulating wealth. There isn't just one element to consider when planning your life with abundance; you need to take everything into account, including the way you revitalize yourself.

Your bed should be comfortable, and the energy should flow smoothly throughout the room. You should not have anything under the bed, so that energy can circulate properly.

The bedroom should be painted a soft color that suits your energy so you will rest peacefully. A bedroom should never be painted red. Red is an energizing color and you will not get the proper rest if you sleep in a red room. Fresh air should always be circulating through your bedroom and also through the rest of the house.

If you live in an apartment building as I do, and do not have much circulation flowing throughout, get a small floor Vornado fan and place it near a window. I recommend the Vornado fan because it is the only one I have found that is quiet and doesn't blow too hard. It is the quietest fan I have found on the market. Most fans, even on the lowest speed, tend to move too fast. Ceiling fans turned low are also a good way to circulate energy. Ceiling fans should not be placed directly over your bed.



Your bedroom should never have a mirror that faces the bed, as it interferes with restful sleep. Mirrors should not be placed behind your bed, at your feet or by the side of the bed. It is an old Chinese belief that your spirit leaves the body and rises as you begin to sleep, but becomes frightened when it sees itself in a mirror. It then rushes back inside the body with the result that you never get a good night's sleep.

The Chinese also believe that a white coverlet is unhealthy because it is the color of the shroud that covers the dead. It is also considered unhealthy for your feet to face the door, because that is how they remove dead bodies from a room. There is a saying in Feng Shui that when you sleep with your feet facing the door you will

never stay at home. You will find that you will want to be on the go all the time and never feel relaxed when you are home. You will be on the go constantly.



Your bed is one of the most important things you have and should be replaced every time you move. It should also be replaced under the following conditions for the fresh energy a new mattress brings:

- If you have had your bed for a long period of time, perhaps five years or more, you should replace it.
- If you have a bed where other people slept before you
- If you or your partner have been seriously ill, your bed should be replaced with a new one.

Ceiling beams in a bedroom are quite unhealthy as they disturb the flow of ch'i. They should be avoided in all the rooms but especially the bedroom. Have them covered if they are open. They

block the flow for energy to circulate. They also cause financial problems. Wall beams in corners of the room have the same effect. Green plants placed by the side of the wall beams help deflect some of the negative energy, as will a wind chime hung from the ceiling in front of the beam.

### FAVORABLE SLEEPING DIRECTIONS TO FACE USING YOUR KUA NUMBER

KUA NUMBER	1	NORTH	SOUTH	EAST	SOUTHEAST
KUA NUMBER	2	SOUTHWEST	NORTHEAST	WEST	NORTHWEST
KUA NUMBER	3	EAST	SOUTH	NORTH	SOUTHEAST
KUA NUMBER	4	SOUTHEAST	NORTH	EAST	SOUTH
KUA NUMBER	6	NORTHWEST	SOUTHWEST	WEST	NORTHEAST
KUA NUMBER	7	WEST	NORTHEAST	SOUTHWEST	NORTHWEST
KUA NUMBER	8	NORTHEAST	SOUTHWEST	WEST	NORTHWEST
KUA NUMBER	9	NORTH	SOUTH	EAST	SOUTHEAST

**FAVORABLE**

CHESTWITHOUTMIRROR      PLANTINCORNER

THERED  
ARROWSONALL  
DIAGRAMS  
SHOWWHERE  
THEFEET  
ARE  
POINTING. WHILE  
YOU SHOULD BE  
FACINGTHE  
DOOR. MAKE  
SUREIT'S AT AN  
ANGLEANDNOT  
STRAIGHT-ON

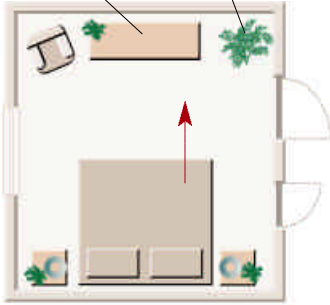

PLANTCOVERSPROTRUDING  
CORNERPOINTINGATBED

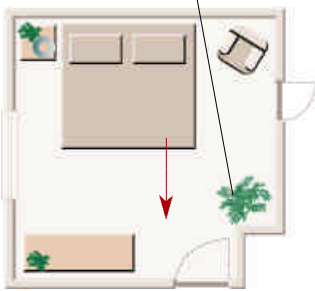

ALTHOUGH HAVING A PROTRUDING  
CORNER AND A MISSING CORNER  
IN THIS LAYOUT, THE SUBJECT  
PLACED A PLANT OR WALL MIRROR  
TO CORRECT IT

**UNFAVORABLE**

TOOCLOSE TO BED

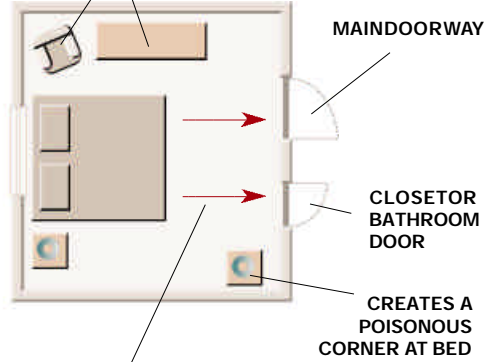

FEET STRAIGHT AT THE DOOR

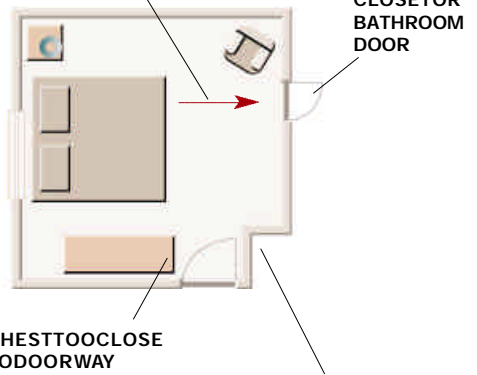

CHEST TOO CLOSE  
TO DOORWAY

PROTRUDING CORNER RESULTING  
IN A MISSING CORNER AND SHARP  
EDGE POINTING AT THE BED



## Dining in the Round is Beneficial to Relationships.

The dining room should be centrally located in the home in order to ensure an abundance of good ch'i energy. Food is important in keeping you healthy and happy.

Round, oval and octagonal tables are more beneficial than square or rectangular tables, as there are no sharp edges to separate people. If you have a square table, try to get one with rounded corners.

The dining room should be well lit, with pictures placed on the wall that are relaxing to look at and soothing to the nerves.



Eating in a quiet place, or a place containing soft music, is very good for digesting your food. A crystal chandelier placed over the table ensures sparkling ch'i energy.

At one time, everyone used crystal for chandeliers, but with the passing of time, crystal has often been replaced with other materials. They hold no value now from a feng shui point of view, unless, of course, they are crystal.

The dining room is one of the best places for a large mirror. This “doubles” the food (abundance) and ensures good ch'i. However, mirrors should never be placed so that they cut the heads off of you or your guests. The mirror should cover one wall of the dining room, and mirrored squares should be avoided.



## The Kitchen - Where Wealth & Abundance is Created

The kitchen is one of the most important rooms in the home according to feng shui. Food prepared here indicates the quality of life one lives, and strongly reflects wealth. And it all begins with the stove!

The Chinese believe the kitchen and the placement of the stove is critical to the accumulation of wealth. The placement of the stove in the kitchen can bring extreme good luck to the owners, ensuring wealth and abundance. The stove can also ensure for the owners, a place of high position in the business world.

If you are not having enough luck in your life, one of the first things to take a look at is your stove and its placement.

The stove and oven should be kept clean, with all burners working at all times. If anything breaks or malfunctions, make certain it is fixed as soon as you notice it is not working.

The kitchen door should not face the front or back door; otherwise your luck flows out these doors. The stove should not face the back door, either, for the same reason.

The kitchen is another fire element, and therefore red should be avoided in this area of the house. If you have too much red in the kitchen, you are more likely to have a fire in your home.



Nothing higher than your head should be hung in your home, especially in the kitchen. You must feel comfortable when you are preparing the food. I see pots and pans hanging over the stove or center of the kitchen in many homes, but this is not a fortuitous placement.



## Be Extra Carefull with Bathrooms

Many people in America do not understand the importance of keeping the bathroom door closed and the toilet lid down. Europeans and Asians have no problem with keeping their bathroom doors closed. Whether in your home, office or business, this is one of the most important elements for having and keeping wealth.



The Chinese say you flush your wealth away if you do not keep the bathroom door closed and the toilet lid down. The Bathroom is a water element, so blue and green colors are good to be placed there. The bathroom should never have red in it as the fire energy conflicts with the water element.

The bathroom should never be placed in the wealth section of the home (the Southeast section). I once conducted a feng shui for a lady in Southern California. When her husband remodeled their house, he added an extra bathroom in the wealth section. Shortly after remodeling, he went bankrupt. She told me he died a short time later from the trauma because he could not handle being in that position.

It is very important to keep the bathroom door closed at all times, but especially if you have a bathroom that adjoins your bedroom. If there is no door, only an entrance, hide the doorway with a curtain or screen. A lot of modern homes are made with no bathroom doors.



You can counterbalance the negative force by placing the opposite color, if the bathroom is placed in an unfortunate place in the house.

- Washers in leaky faucets should be replaced immediately, for leaky faucets slowly leak away your finances.
- The proper placement of the bathroom in the home is also an important element for accumulating and keeping wealth.
- The head of your bed should not be placed on a bathroom wall as this placement is detrimental to your health.





## Watch Your Back While at Work

Whether you work at home or in an office, never sit with your back to the door, and try not to face a wall.

Facing a wall can make it seem as though you will never get ahead, as your progress is blocked. If you do face a wall, and it is impossible to rearrange your desk, a mirror placed on the wall in front of you will help to some extent remedy the situation.

Many offices today have cubicles where people are all crowded together. If this is the case and you must sit with your “back to the door,” a small mirror on the wall in front of you will allow you to see people approaching from behind. You’ll find this small adjustment will increase your comfort level. It isn’t conducive to good ch’i energy to work with your back to the door or to other people. If your back is to the door or to other people, you are opening yourself up to get stabbed in the back.



Your back should not face a window, either, as you will not have the support you need. If this is not possible, keep the window covered with drapes or blinds, and place a large green plant by the window or in front of it. You can also use a screen for the same purpose.

Never sit directly in front of your office door. Try to sit at an angle so that you have a good view of the door, but are not directly in front of it.

If you work in a home or outside office, always try to sit facing your great prosperity direction. If that is not possible, sit facing one of your three other good directions, preferably your overall harmony direction.

Place objects like a globe, in the proper directions in your office the same way you would in your home. If you work out of the home, the office space should be activated with symbols to enhance the flow of money energy.





## Those Beams Overhead are Unfriendly to Healthy Ch'i

Overhead beams should not be exposed in any part of the house. They will stop the flow of good ch'i energy. When exposed in a home, they bring a feeling of oppression and can stop the flow for money and wealth accumulation.

When the bed where you sleep, or where you sit at work have exposed beams overhead, they can cause ill health, bad luck and business problems. Sleeping under an exposed beam can cause severe illness.

If your desk is directly under an exposed beam, you will have a difficult time achieving your full potential in the business world. Ceilings were never meant to have exposed beams. The best ceiling should have a flat surface and if at all possible, have rounded edges at the corners.



Standing beams protruding from corners can cause problems in any section where they happen to be. For instance, beams in the marriage corner can foster conflict and divorce, in the wealth corner they cause the loss of money, and in the knowledge corner, lack of education for you or your children.

If you have such large beams (square columns) placed in corners, you can camouflage the edges by putting plants in front of them. You can cover the sides of the beam with mirrors (except in the bedroom), and flowers will also help the flow of energy.

Hollow wind chimes can also be placed from the ceiling close to the beam, and this will help the flow of energy to pass by the beam. They are not as effective as the plants or mirrors, but if you cannot do anything else, you can use chimes.



## Replace or Repair Broken Items & Don't Overcrowd

Everything in your home should be in working order. If you have a broken chair, replace it or get it fixed immediately. If you have chips on some of your dishes, get rid of them.

It is not good feng shui to have chipped dishes, or anything in the kitchen that is not working. Replace anything in the home that is not working properly, especially burned out light bulbs, leaky sinks, and broken or cracked windows and doors. Everything should be in proper working order, or your resources will drain away.

The computer you work on daily should not have cords going in every which direction. Use a large funnel cord to put all the small cords in so they look neat and tidy.

Another important aspect element in promoting good feng shui is avoiding overcrowding. When you have too much “stuff” in your environment, energy does not flow easily. It is better to have less in a room so the ch'i can move comfortably. You should feel relaxed and secure in every room of the house.



Speaking of every room in the house, every room in your home should be used. I have done feng shui consultations in huge homes to where much of the house is not used. You can feel when rooms are not used. They hold dead energy. It is very important to use every room in order to circulate the energy to all parts of the house. If a room holds dead energy, that room exerts a bad influence on the rest of the house and can cause illness to the people who live there.



## Those Furry Creatures You Love are Wonderful Feng Shui

Pet lovers will be happy to know that having a pet in the home is good for feng shui. Pets move around and help circulate the energy.

But, please, do not have pets if you do not like them or can't take proper care of your pet. It will produce negative energy if you have pets and don't take the time to treat them properly.

If you live alone, pets can keep you company and will help you from being lonely or feeling alone. Pets have been proven to keep people healthy because of the company and energy they provide.

Dogs, cats, birds, goldfish, or anything living will bring good energy into the home.





# Clean, Organize & Clear to Make Room for What you Want

Keep your home and office clean! Don't be afraid to throw out old files with old energy. Throw those files away and new business will come to you. Throw away letters from former lovers and you'll find someone new!

Cleaning out clutter and keeping your home and office neat and tidy is one of the first steps toward "activating" your sectors ruling health, wealth and romance. After cleaning out the clutter physically, clean and straighten up the place, vacuum, sweep and mop all areas of the house. This should be done at least once a week.

Allocate different corners to each individual in your household in order to maximize and enhance your wealth section. If you find that you do not use something within a year, get rid of it. Once you dispose of things you no longer use, you make room for new energy and opportunities to enter.



## SMUDGING

After each cleaning of your home of clutter, there is a procedure that is called space clearing or smudging that should be undertaken each time, using white sage, candles and bells. This is a very important course of action for clearing away negative energies. I clear negative energies with each feng shui I do. It gets rid of dead energy and brings new life into the home.

At first, some people are concerned and feel a little apprehensive with this procedure because the procedure isn't something they're familiar with. Smudge clearing raises the level of vibrations in a place. I tell the people it is not, "good" or "bad" energy, it is just static energy that needs to be dispersed to make way for clearer and more active energy. Clearing energy allows good ch'i to enter so that your home will be fresh, clean and alive.



If you are concerned about aspects of the procedure, think about how the Catholic church uses frankincense and bells during services to spiritually uplift worshippers, the early American Indians who routinely used peace pipes and smudging. They cleared out energy with smoking of the pipe and a chant dance. All cultures have used some form of space clearing since the beginning of time.

Homes and offices can benefit from being cleared out at least once a month. After clearing the space, light a white candle and let it burn for a while.

When I clear energy by smudging, I get the whole family involved. The children love it and any pets like to be around when it is going on. Animals can see the energy changing and are very interested in watching it move. The amount of time it takes to clear and smudge depends on the size of the house.

Speaking about the size of the home reminds me of a friend who said I should mention, that it isn't the size of a home that makes for good feng shui. You can live in one room and still have wonderful feng shui, and live in a mansion where it is not nearly as good. But the size of the home takes a certain amount of time to clear the energy. After I help the people clear out and rearrange furniture, I sometimes spend as much as two hours smudging and clearing with bells or gongs. When you feng shui it takes time to tune to the space. I recommend doing some deep breathing exercises as it helps to tune into the space. When you are doing this procedure, it is important for you to feel this connection with your space. You must be relaxed in order to accomplish this.

Start at the front door and go around the perimeter of the house feeling and sensing the energy. Once you do this, you will be amazed to discover how you can feel stagnant or alive energy in different rooms. Since your home is already familiar to you, it will be easier to tune in if you sit quietly in each room and try to feel the energy. If you have an affinity with animals or plants, you will find that you have an affinity with buildings, too. Buildings have energy just as animals or plants, you just have to tune into this energy to help release suppressed energy and move it so it becomes alive again.

If your home is more than one floor, start at the bottom of the building and move upward to each level. Energy always stagnates at the bottom. If you have a basement, start working with the basement first. Most people have cluttered basements, and if this is the case, get in there and clean it out. You will be amazed to see what a difference you'll feel and how your life will change.



## Flowing Water - The Premier Wealth Enhancer

Water is the most important element for earning money, and the wood element most important for retaining wealth once earned.

Water is the elixir of life. We are not able to live long without it. It is the only substance that is absolutely necessary in order to have a healthy body and mind. It is also the element that rules the career section. Without our careers, we would not feel self worth, and certainly not have the money it takes for living in today's world. Its direction is north. Water can be placed in the north or southeast section of your home. The southeast section is the prosperity corner. The placement of water in this area, along with a luxuriant green plant, will be beneficial in attaining wealth. Wood is the element that rules the Southeast and consequently, water is beneficial to the wood.



Activate these two sections by using bubbling fountains (and be sure to select one where the water bubbles up instead of running down) or fish tanks. Keep both clean, as stagnant water has the same effect on your financial position.

If your front door faces North, East, or Southeast, place a small fountain at the entrance on the right hand side of your front door. The right hand side is coming into the house. Left hand side entering the house is not a lucky placement, but the right hand side increases finances and helps with overall harmony in the home.



## Color Yourself Healthy, Wealthy & Loved

Become familiar with colors that can enhance your potential (and those that can detract, too). You'll find your lucky colors in the section on directions (and in the PaKua on page 29). Use your lucky colors for house and office colors, the color of your car, and even clothes.

Color is especially important when used to balance out the five elements. Color creates harmony, which creates good feng shui. But caution should be used. For example, red is the color best known for attracting anything and is the strongest and most powerful color of all. But, if it is used in the wrong location or if it is not lucky for your special Kua number, it can be detrimental to your health. A little red can always be used, such as splashes of red here and there, but of course, not a lot

If your color is gold, you can use lots of the color gold, but not much green. Green is unfavorable to your health, because it is opposite your color on the PaKua and therefore unfavorable to a gold person's health. Red is beneficial to you if your color is gold. You can mix red and gold together, but remember, it should be placed in the South or West, as your Kua number is #2, with the color gold.



Be sure to familiarize yourself with the PaKua, your element and best directions so you know which colors are beneficial to you, and which one's are to be avoided.



## Lucky Objects to Place in your Environment

The Chinese believe in the symbolism of all things, including animals for a better life for longevity, health and happiness.

The lions, deer, elephants, turtles, horses, frogs and the three important gods placed in your home will ensure a well balanced life of abundance. We can easily see the influence of the past in Europe, where we see guardian lions providing protection to many front doors of businesses and homes.



Three lucky gods are Fuk, Luk and Sau. I have never been in a Chinese home that did not have these three gods. They should be placed in a high position, or position of prominence, in your home or office.

Shortly after I got mine, a friend came to visit and was staring at the little guys. Finally she said, after a long time of looking at them, “They are the three wise men from the East that came bringing gifts when Jesus was born!” I had never thought of it in

that way, but it makes sense. They are of great importance to the Chinese people. Fuk is the god of wealth and happiness. Luk is the god of importance and affluence and Sau is the god of health and longevity.

There are so many things you can use to create more abundance in your life.

Bright lights placed in dark spaces of your home enhance your chances for making more money, especially when placed in the wealth section.



Crystal chandeliers, thriving green plants, fresh flowers, fountains, fish tanks, wind chimes, brass bells and lots of color should be in each and every room in the house, including the kitchen. Paintings in the kitchen and dining area should be of fruit, flowers and food.

Heavy sculpture pieces and statues produce yang energy, while yin energy can be activated with bright lights and sounds from background music and chimes. Paintings and pictures that symbolize happiness can be placed in different rooms for a calming effect. Avoid any kind of art that suggests unhappiness. Never place a picture with a person's back to you in any room in the house. You will have people leave your life if you have any such pictures.



Paintings should be with more than one person or animal to ensure happiness in your love life. Single people in paintings suggest being alone. If you have any paintings like these, replace them with happy and healthy pictures of people or animals.

Turtles are also considered to be lucky, as are frogs.

# Pay Attention to Directions

## NORTH

Represents the flow of energy for earning money and should be activated with the color blue and the element of water.

North is considered cold and damp. It is the wintertime, when things lay dormant. Water produces wealth. We cannot live without water. We also cannot live without having money in our lives, so this section is very important to both our health and wealth. Water fountains, fish tanks and even a picture with the view of water are all important ways to enhance the earning of money.

If you are an East group person, you can have your door facing north. It is not a good direction, however, if you are a West group person. North can be activated to bring in money for both East and West people. It may be a little confusing, but as time goes by and you as you become more familiar with feng shui, you will have a better understanding of the elements with the directions and colors. Feng Shui is such a deep subject you cannot possibly get all the information from any book, but it is a beginning.

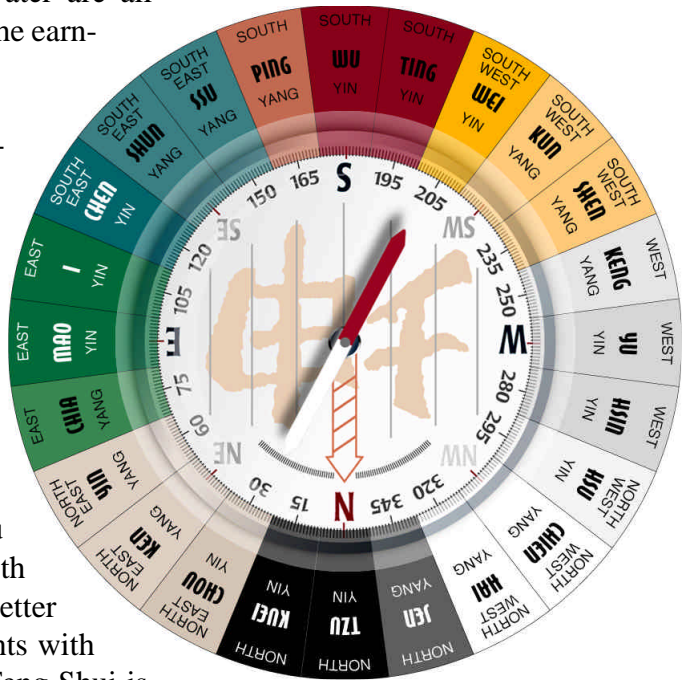

## NORTHEAST

Represents the flow of energy for knowledge and should be activated with the color gold. The earth element is for the Northeast section. The earth element represents wisdom, honesty, and reliability. Placing clay, crystals or a bookcase in this section will encourage the gathering of knowledge. Place a photo here of the school you wish your child to attend.

**EAST**

Represents the flow of energy for your health and well-being. This element rules springtime. It is the time of year when all plants and things in the earth come to life. The sun rises in the East. Wood is the element that helps us to stay healthy. If you do not have enough green plants or living things in your environment, you will not feel alive. Green plants or a nice bamboo plant placed in this section helps you achieve a happy, healthy life.

**SOUTHEAST**

The section of the wood element. This section represents the money or wealth section of the home. In this section of the house, it is very important to place a flourishing green plant, a small fountain or fish tank, and a red envelope containing some coins. If you are an East group person, you could paint this wall green.

**SOUTH**

The section for the flow of fire energy. We could not live long without sunlight. Fire and South represents the sun, and the heat created by the sun. This is energy created during the summer months of the year. American Indians realized the value of fire, which is a regular part of their ceremonies. The Kitchen is of the fire energy. It represents the stove, without which we could not eat properly.

The fireplace in your home is considered part of the fire energy when lit. This section represents the energy we send out to the world and what we get in return in the form of fame, success, wealth and recognition.

**SOUTHWEST**

This is the flow of the earth and symbolizes one of the most important elements, your marriage or relationship. Everyone is looking for a good relationship if they do not already have one. Sometimes it seems this is the hardest thing of all to come together. The colors to place here are yellows and gold tones. Use a pair of things, like mandarin ducks or crystal swans. Anything crystal in this corner helps to activate your romance or love life. Mandarin ducks have brightly colored plumage and a crested head.

I have done many feng shui consultations for people who are single and want a relationship. When I go into their homes, I commonly see an abundance of single things: single people in pictures, one bird, one candle, a single flower, and so on. Things should be grouped in pairs to set the stage for a good relationship.

## **WEST**

Represents the flow of energy for your children's health, their schooling and overall well-being. This is where the metal element rules, and the color white, which is considered pure.

Placing copper, brass or other metals in this area helps to balance out this section. Metal is the element that needs to be balanced the most in order to feel in harmony with life. Venus rules this element, and as you know, too much Venus or too little throws us off balance. Most business offices have too much metal and are often out of balance due to the fact they do not have enough green plants and other elements to offset the metal.

## **NORTHWEST**

It is also of the metal element. This area is the section that rules our benefactors or mentors. Place a metal statue in this area to give you support, or an image (in an attractive metal frame) of a person who can help your career.



# The PaKua - A Compass for your Life

Included on the PaKua, the eight-sided octagon instrument, are the directions, colors, elements and everything that affects an individual.

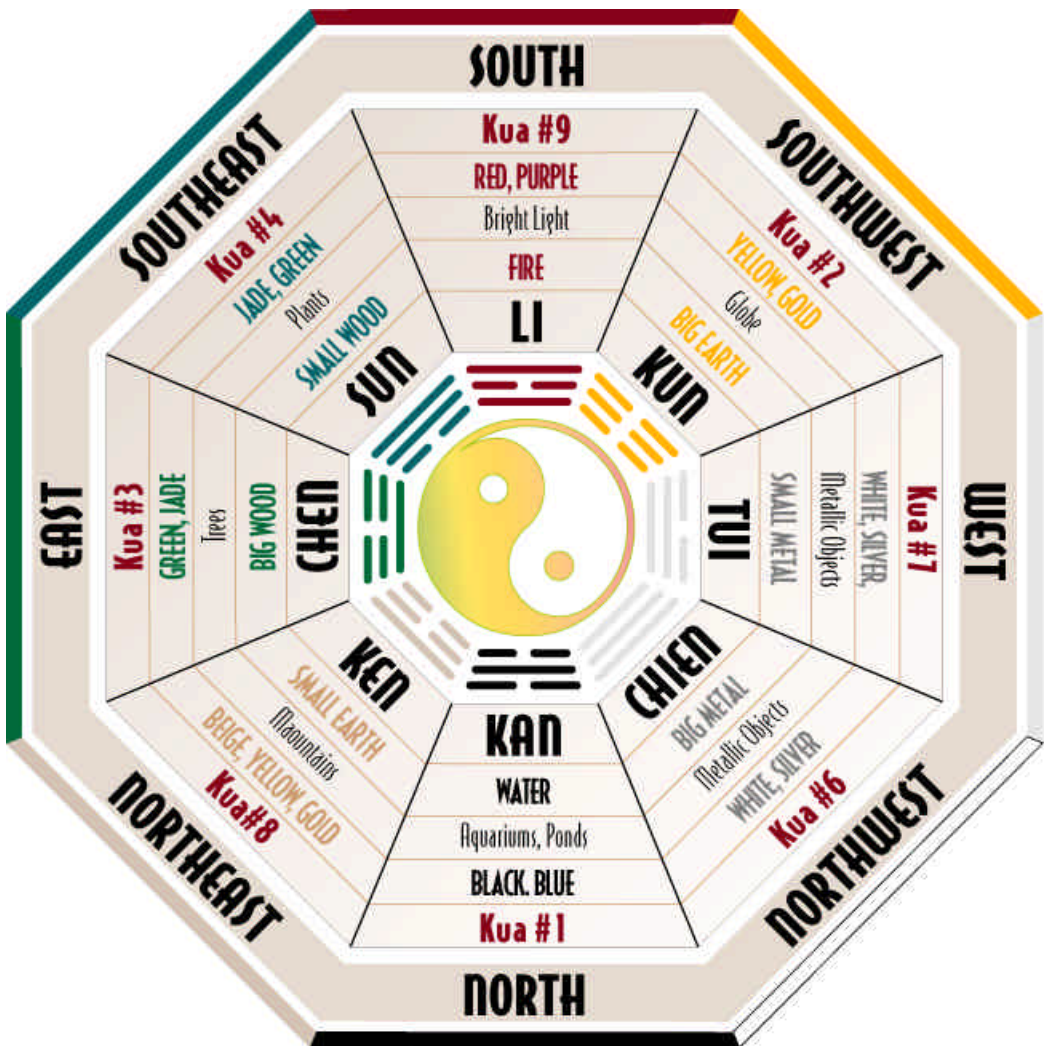





There are four lucky directions and four unlucky directions and they are all different for each person depending on their Kua number. When you make changes, the methods you use to eliminate negative energies need not entail elaborate adjustments. The solution usually lies in changing your furniture, removing dead plants and clutter, and placing symbols such as green plants, fountains, and goldfish tanks.

A number of things will help you attract more money, enhance your love life and guard against ill health.

You must not have sharp pointed objects from the outside or inside pointing toward you as you work or sleep. Sharp points inside can come from corners of tables, bookshelves, and sharp objects hanging on your walls (ornamental swords, for example). Outside your home or office, things like houses, buildings, church steeples, telephone poles, street lights and power lines can provide “poison arrows.” Guarding against all of these things plays an important part in staying healthy, happy and succeeding in your business and personal life.

Maintaining good ch’i energy in both your home and business is the source of peace and prosperity. Having too much fast, flowing energy is as bad as not having enough. All things need to have balance. Too many windows or doors aren’t good for a home, nor too few.

An important part for ensuring good Feng Shui is the proper interpretation of the elements in their productive cycle. There are five elements that cover the nine sections of the home and the property. Placements of these elements are all important.

				
<b>FIRE</b>	<b>EARTH</b>	<b>METAL</b>	<b>WATER</b>	<b>WOOD</b>
TRIANGULAR DIAMOND POINTED SHARP	SQUARE LOW FLAT WIDE	ROUND DOMED OVAL ARCHED	IRREGULAR CURVED WAVE	TALL RECTANGULAR THIN
RED PURPLE	YELLOW BEIGE GOLD	WHITE SILVER	BLACK BLUE	GREEN JADE

**PRODUCTIVE CYCLE**



**DESTRUCTIVE CYCLE**



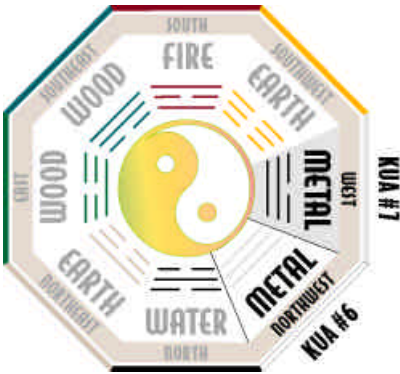

**The Metal Element** represents the west section and the color white. This is also the health of the children, their well-being and family life in general. The Kua number is Seven. Seven is of the west group people. The metal element also represents the Northwest section. The color is also white. This is the benefactors section and should be activated by placing pictures of objects or places or people who will help you on your path to success.

**The Earth Element** represents the center of the house, and the Southwest sections. The Center encompasses all of the elements. Southwest represents the color gold, the marriage corner, family happiness and the Kua number Two of the PaKua. Two belongs to the West group. The Earth Element also represents the Northeast section and the color for this section is gold. This section should be activated if you wish to gain knowledge or want to go back to school. Also, if you wish your children to get a good education, this is the section where you should place the best edu-

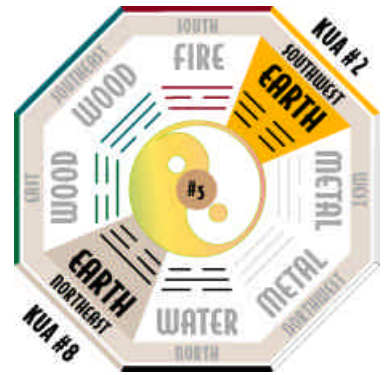

catinal books and pictures of the schools you want your children to attend. The Kua number for this section is Eight.



**The Water Element** represents the North. This section rules the career, and the ability for making money. Its colors are blue or black. The Kua number is One. This section should be activated if you want to get ahead in your professional world.



**The Wood Element** represents the East. The Kua number is three. The color for this section is the color green. It is also the section for health. If you want the quality of your life to improve, along with your health this is the section that should be activated with green plants and bamboo. Bamboo is considered to be the best element to be placed in this section.

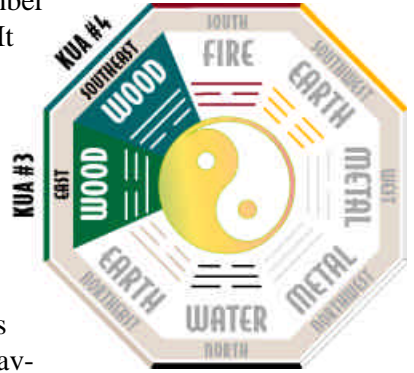

**The Wood Element** also represents the Southeast. The color is also green or jade. This section represents the wealth of the family and saving money. The Kua number is

Four. If you wish to have money,

activate this section by placing green plants, a red envelope with a few coins inside, and since the element of water is beneficial to the wood element, you can also place a small fountain or fish tank in this location.



**The Fire Element** represents the South section.

The color for South is the color red. It represents your ability to become famous. South's Kua number is Nine. If you wish to become well known and successful in your field, activate this section by placing a horse, turtle, or elephant (with the trunk up) in this area. You can also place a world globe in this section of the house. The globe placed here and twirled from time to time will insure your work goes around the world.

You should definitely place something with the color red in this area of the house. Red is powerful for attracting anything, and is considered to be the strongest color of all. All forms of red colors, such as purple, mauves, and dark orange are considered to be of the red color. You must be careful how and where you use colors in your home. If used in the wrong location and not lucky for your special Kua number, they can be detrimental to your health. Again, the keyword is balance. Balanced color in your home is good. If your color, for instance, is gold, you can use lots of gold, but you must use caution with green as that color would cause health problems. Knowing the importance of color and balancing its placement is most important. If you are a Fire person, you can use lots of red in your home, but too much metal or the color white would not be good for you. If you are a water person, you can also have too much white in your home. Greens and pale blues would be good for you. Green is a good and lucky color if you are of the water or wood element. Plants and water fountains are also good for the wood element.

Crystals are beneficial for the marriage or romantic section, the southwest section of your home. A pair of crystal swans placed in the marriage section ensures happiness in your love or married life.

Understanding the eight trigrams, which are part of the PaKua, can give you valuable information for improving your life. The meaning of the trigrams seems complicated at first, but they can offer valuable clues to help balance and attract things to you.

**COMPARING THE COMPASS, PAKUA, MAGIC SQUARE AND 24 DIRECTIONS OF THE LO PAN TO SHOW THE CONNECTION BETWEEN THEM**

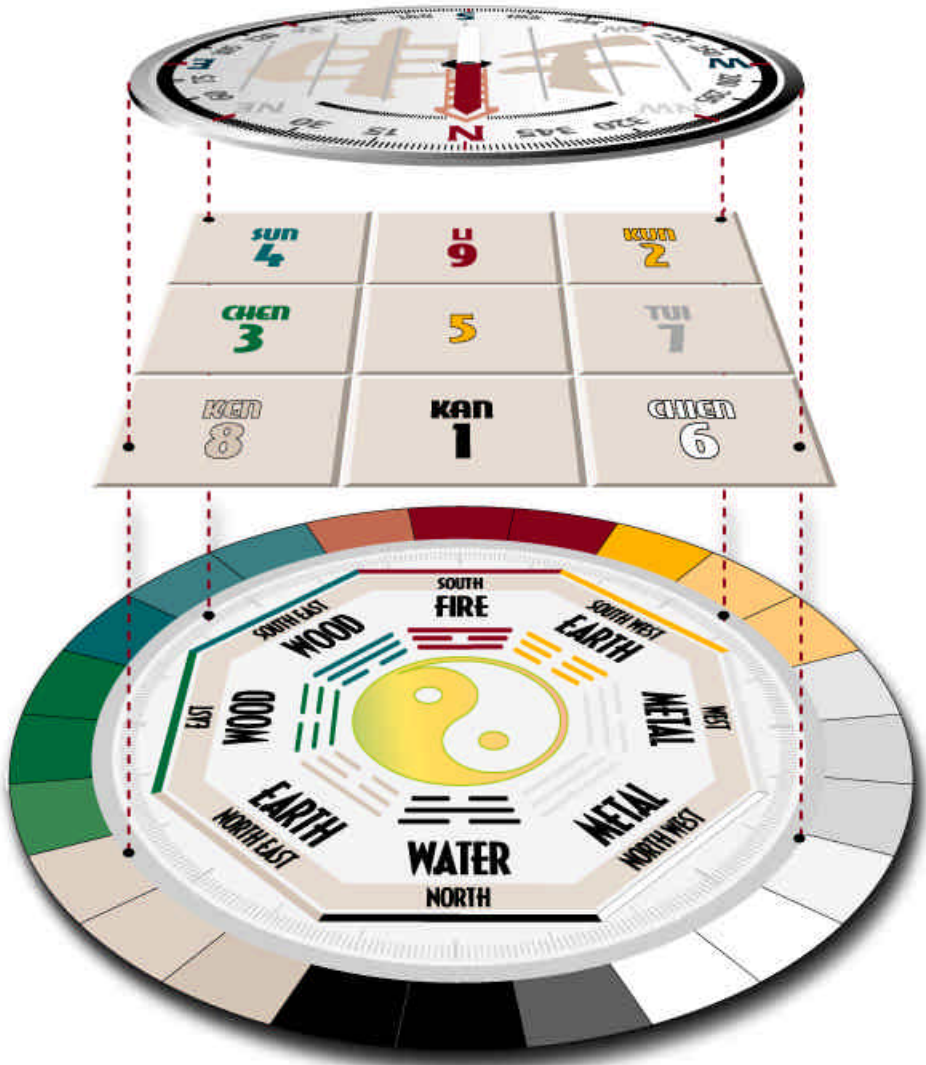

When you go deeper into the I Ching, you find there are 64 trigrams or hexagrams. The eight trigrams of the PaKua consist of the 64 hexagrams. Once you decide which part of your life you should work on, get busy and activate that section of the house, using remedies like bright lights, mirrors, crystals, live plants, fresh flowers, fountains, fish tanks, wind chimes, gongs, stones, statues and fans.

Healthy green plants in the wealth and health section and fresh flowers in the marriage section will enhance your love life. Flowers are also beneficial for the marriage section, as are green and flowering plants for the wealth and health sections.

Be sure to keep all plants and flowers fresh and alive. Do not keep any dried or dead plants around the house. They create negative energy, bringing bad luck and poor health.

**APPLYING THE PAKUA TO INDIVIDUAL ROOMS IN THE HOUSE**

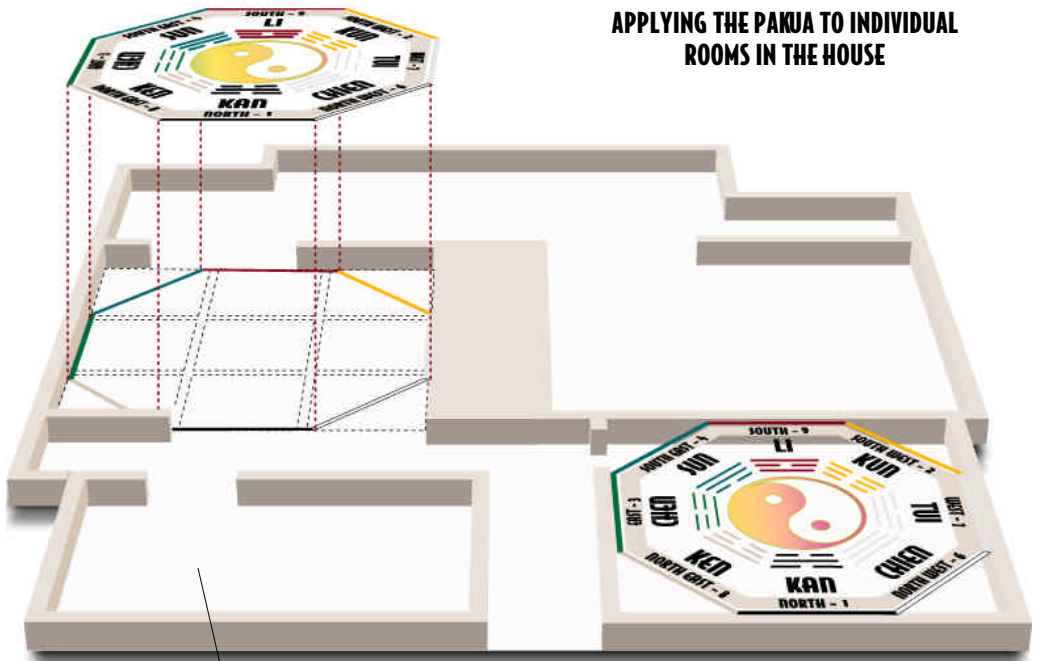

**FRONT DOOR  
FACES NORTH  
WHEN EXITING**

Applying the Pa Kau gives you the location of the sectors in each room exactly as it would to the whole house. The Magic Square outline shows precise areas to apply each of the Five Elements and good Feng Shui objects.

Notice that Kan or Kau Number 1, which represents North, is in the same direction as the front door.



## Activate your Wealth Corner - Southeast

The wealth or money corner is the Southeast section of a room or house. You must also activate the North section, as this represents the career section that brings in money.

You can place a small red envelope with a few coins of money in the southeast section. Crystals cannot be placed in this section unless it is citrine. Crystals are unlucky in the Southeast except for citrine. Citrine will enhance your money energy.



As this section represents the wood element, thriving green plants placed here will also increase your opportunities for increasing your income. Using the North element of water in your Southeast section in the form of goldfish tanks, or small water fountains will also bring luck with finances.

There are different formulas and methods for better living and working conditions. Irrespective of the methods used, all symbols bring the same results.

The southeast section is the most important to activate when you want to improve your financial situation. The wood element is at home in this area, so bring in a lush green plant. Make sure this area is filled with a bright light.

In my home, I have placed in this area a small Wells Fargo Stagecoach bank that someone gave me as a gift. The bank is full of coins. Since water is beneficial to the wood element, a small fountain or fish tank placed here will bring more money.

Metal should never be placed in this area except for a few coins in a red envelope.



## Marrige & Romance Corner - Southwest

Feng Shui can enhance your love or married life. If your love life is inactive, you will see a change in your luck when this part of the house is activated.

If you feel that your marriage needs reviving, this is a sure corner to work on and activate immediately. The section that rules marriage and romance is the Southwest corner of your home. You can also activate the southwest corner in each room, placing fresh flowers there. If you cannot place fresh flowers weekly in the home, artificial or silk flowers will do). You will find that fresh flowers provide much better energy.

Never, never use dried flowers or have dying flowers or plants around. Dead or dying flowers have a very negative influence wherever they are placed.

Cacti, or thorny or prickly plants, can cause arguments among family members. Luxuriant green plants with large leaves placed around the house bring good energy, but be careful about placing too much green in this corner. This corner is of the earth element, and plants (considered to be wood) are not an inherently beneficial element.

Placing a pair of crystal swans or mandarin ducks or a pair of anything in this section will activate love or romance. Crystal is the primary element for the southwest section, so anything made with crystal would be better.



Bathrooms should never be located in this section of the house. A bathroom here is a sure sign of problems in a marriage. If a bathroom is located in this section and you have other bathrooms in the house, use the others and try not to use this one. Place a mirror on the door and keep the door closed at all times with the toilet seat down.

If you find that you have been happy in your marriage until you move to a new location, the feng shui at your new location is probably not as good as your previous one.

Mirrors should never be placed in the bedroom by the side of the bed, at the foot of the bed or over the bed. Having a mirror reflecting the bed is a sure indicator of problems between couples. Mirrors should be placed in the dressing room or bathrooms, not in the bedroom.

Water is detrimental to the marriage corner. As the element for the marriage section is earth, water is the worst element to be placed here. Having water on the right hand side of your front door as you look out is another sign for problems in the marriage. The left side of the door is sometimes lucky for water at the side of your front door, but only if your front door faces north, east or southeast. East is of the wood element and water is beneficial to wood. North is the direction of the water element, so placement in this section is fortunate. Water placed on the west section of the house is very unlucky.

It is very important to place things in your home so that you have a happy home life. One time, I was consulting with a couple that were going through a divorce. The husband had asked for the divorce. While he was gone on a week's business trip, she called me to do the Feng Shui. In the marriage corner, this section had a large square beam. We covered the post with a picture of a couple walking in a green field. Some homes have this section missing from the house, as sometimes happen in houses with unusual shapes. Their bedroom had a lot of clutter that we cleaned out. The bathroom door from the bedroom was always left opened. We closed the bathroom door and put the toilet lid down.

When the husband returned, he told my client that he had changed his mind and did not want the divorce. That was four years ago and they are very happy to this day. So you see how powerful Feng Shui is, and how quickly it can work.



## Health & Family Corner - East

Due to the developed (and sometimes overdeveloped) areas we are living in at this time, it is more important than ever to implement principles of Feng Shui in our environment so that we may have good health.

Not so long ago, the majority of people lived in the country close to nature, which is good from a Feng Shui point of view. Most people are now city dwellers because of the need to be near their work.

In this new world of modern technology, this, too, is changing. More and more people are connecting and working with their computers through the Internet, giving them the ability to work from a home in the countryside. This will almost certainly produce healthier individuals. We have almost forgotten how important exposure to nature is to our health and well-being. Feng Shui is a reminder to pay attention to the revitalizing effect nature has on our inner being. Feng shui teaches us that certain places have better energy than others. Living near nature is a sure sign of having better health, and gives us energy, vitality and the zest for living. Once feng shui principles are implemented, we feel healthy, alive and filled with energy.

When we live in a city, it is necessary to activate our surroundings in order to achieve a healthy body and mind. If you live in a place where you are always ill, you may be located where the energy running through the veins of the earth is detrimental or incompatible with your energy.

Another possibility with ill health or fortune, is living in a place where “poison arrows” shoot at you while you sleep or work. Poison arrows are any sharp, pointed objects, including sharp corners from other buildings pointing toward your front door or bedroom. If you are sleeping or lying in the direct path of such energy for long periods of time, this can cause ill health to the point where you will not be able to recover.

These poison arrows can also cause you to lose your wealth. Having financial problems can also contribute to ill health.



In our modern day-to-day life, we sometimes ignore how and what we are feeling. If we paid attention to our bodies, we would not have as many health problems. If you are feeling less energetic, you should perhaps think of making changes in your environment, or even moving to a new residence.

We must get back to listening to our inner selves and paying attention to our feelings. If we do not have our health, life will not be worth living. When we are not well, we cannot enjoy everything that life has to offer. So it is of the utmost importance to live in a place where you feel good.

Your bedroom should be airy and have good circulation. If you do not have good circulation in your bedroom, buy a Vornado fan and turn it on low. You cannot hear it running and it circulates the air for you while you sleep.

Activating the health section can certainly help your health. If you are having health problems, place a bamboo plant on the east side of the house and make sure to keep this space clean and uncluttered. You can also buy a small little carved gourd called a “wu lou” and place it in this section. If you are an earth person, buy a crystal one; if you are a wood person, be sure to buy a wood one. If you are a water person, place a container with water in this section. If you are a fire person, place something with a little red (not too much) in this section to improve your health.

I once did a consultation for a lady who was going through a divorce. She had recently moved from her home where the feng shui was bad, into a new home with good feng shui.

She had three children, and each time the children went to visit their father, they all came back to the new home ill.

Remodeling and building a second story onto the first house caused the divorce. The front door opened directly onto a stairway that went straight up and on the landing was an open window. Needless to say, all the good ch'i energy raced up the stairs and went out through the upstairs window.

The husband was having a terrible time financially and yet refused to pay attention to any suggestions I offered to help improve his life. I tried to help because of the children and their health. He remains ill most of the time.





## Benefactors & Mentors - Northwest

In your Benefactors or Mentors corner, place pictures of anyone who can help you achieve your goals in this section of your home. You can display pictures of the place of employment, or of your employers.

If you wish to work in a different place, take a picture and place it here. You can place anything metal, such as a statue of someone, in this area. Whatever your profession, putting pictures here of those you wish to be like or would like to follow in their footsteps will increase your chances for success.

I once did a Feng Shui for a lady who wanted to work for a certain company. She took some photos of the company, placed them in this area of her home. After filling out an application, she was called three weeks later to work for them.



## Knowledge & Education - Northeast

If you are interested in furthering your education, have children in school or going away to college, activation of this section will help you accomplish your goals in this area.

If your home is large enough to have an extra room for a library, this is the place where it should be placed. If you do not have the room, put a nice bookcase in this section with good reading material for both you and your children. Educational books placed here will help ensure a good education for your children.

Placing pictures of the schools your children wish to attend in this northeast section will improve their chances for admittance.



## Activate your Children's Corner - West

If it is possible, your children's bedrooms should be placed in this area of the house. Displaying healthy, happy pictures of the children, their friends and family in this area is also important. Children need to feel secure, and having pictures of the family helps to increase their feeling of security.

This is one area where the metal element rules.

Put anything metal to help active the children's mental ability. Metal includes electronic equipment like computers.

Be sure to add bright color to the children's rooms, as this also helps with their growth. Color plays an important role in all our lives, but especially children's. Most people are not aware of how important color is in helping children feel well adjusted and happy.



## Activate your Fame Section - South

Feng Shui is important for attracting success and luck for your career and business. Activating the fame section helps bring you fame, whether it is in the business world or the arts.

If you are an artist, writer or musician, activating this section can help increase your chances for recognition and success. Painting this section of the house red will be beneficial for attaining success and fame. Placing a horse, turtle or elephant in this area assures that you will have strength and power to complete your projects. You can have all three objects to make sure you have strength and determination to achieve success.

Keep this area well lit, the brighter it is, the better. If you wish to become famous, put a world globe in this area and twirl it from time to time. Whatever you have to send out will go to all parts of the world.

Never have water flowing in this area, in the form of a fountain or sink.

This is not a good placement for a bathroom, either. If you have a bath in this area, be sure not to use it if your desire is to become famous.



# Your Element and its Relationship to Colors

If you know your element, it will help you decorate by identifying the best placement of things and the best colors so that you can achieve overall harmony and well-being.

## **WOOD - Green**

If you are a wood element person, you can benefit from using lots of greens, blues, blacks and some reds, but not yellow, gold or white. Use plants and water in your home, but be careful as to the placement of these elements. They belong in the North, South or East section of your home.

## **FIRE - Red**

Fire element people can use lots of reds, greens and blues, but not too much white, gold or yellow. White is a detrimental color for fire, wood or water elements. It causes misunderstandings between family members and friends. It can also cause loss of income. Use lots of the color green, including green plants, and you will see an increase in your financial status. In fact, after red, green is the most important color to be used in your home. Blue is also beneficial, as it enhances the quality of your life by creating harmonious conditions for good relationships between family members and friends. Blue is also a good color to use to help attract partners if you are single. If you have single children in your home, it helps attract a lucky and happy marriage for them.

## **EARTH - Gold, Yellow**

If you are an Earth element person, you can have a lot of gold and yellows in your home, in addition to some browns and reds. Avoid an abundance of green, blue or black as these colors are detrimental to your health. Crystals and crystal chandeliers are beneficial in different locations within the home. In fact, I am an earth element and have every room painted yellow, except for one wall which is red. Red is a beneficial color for Earth people.

**METAL - White**

If you are a metal element person, white, silver and metallic tones are your colors. Yellow and gold are also beneficial to your element. Use all of these colors in your decorating. Green is the worst color you can have in your home if you are a metal person.

**WATER – Blue or Black**

If you are a water person, take care not to have too much yellow, gold or white in your home. Blue and black are your overall harmony colors, but you can use greens, blues and some red. As a water person, with too many gold or yellow colors, all sorts of unlucky things can happen. Yellow or gold are your worst colors. Green is a good color, and lucky if you are either water or wood element. Plants and water fountains are very helpful to the element of wood. The water element can be placed in the North section of the home or the Southeast section. Never place water in the West or Southwest section of the home.



## A Few Precautions

### **MIRRORS**

Mirrors are among the most useful remedies, but they must be used in the proper location for mirrors. Never use square mirror tiles that adhere to walls – they break up images and are considered unhealthy. Never hang a PaKua mirror inside your home. It must be on the outside of a window or door to deflect poison arrows. Keep them away from your bed and out of your bedroom altogether, if possible. Keep them in good repair – if they are old, they may need to be re-silvered so that the reflected image doesn't show the mirror's flaws. Never have mirrors hung to where they are too low and cut your head off or you cannot see your head.

### **DRIED FLOWERS**

Dried flowers and arrangements are very unhealthy to have in your environment. They are dead, and consequently have that meaning wherever they are placed. Use fresh flowers (but keep the water fresh and dispose of when they start to wilt) or silk flowers instead. Scented potpourri is dried flowers and should not be used in the home.

### **WATER**

Water can be very beneficial, but it can also be detrimental if it is placed in the wrong area. Be sure to follow the tips in this book.

Any dripping water from faucets, drains, roofs, etc., will drain your resources. Water problems should be fixed immediately, as they are very detrimental to your financial health.

### **LIGHT**

Burned-out light bulbs should always be replaced immediately, as they are very detrimental to healthy ch'i. It is a good idea to keep replacement bulbs on hand so that you are never "without light"!

Our ancestors had a natural feeling for the principles of feng shui, when you consider the following sayings:

"Cleanliness is next to godliness"

"A stitch in time saves nine"

"Waste not, want not"



## Find your lucky Kua number

Knowing your Kua number is one of the most important aspects in helping you identify your best colors and directions. The directions and colors are different for each person. There are four good locations and four bad locations for each person. Once you know your Kua number everything else falls into place. Your Kua number is part of the PaKua.

A PaKua is the compass instrument used since the ancient times to locate the placement of things for health, harmony, and wealth. It is an eight-sided octagon listing the eight trigrams from the I Ching and numbers from the magic square.

The I Ching is the most ancient book known to man. It is very much a part of everything that is in the universe. It is the key to understanding the world and everything in it. The I Ching has been translated into many languages and with the passing of time and the different languages some of the true meaning has been lost. Nevertheless it has survived. Later after you learn everything contained in this little book you can start learning more about the I Ching. The correct pronunciation is E Ching. I have written much about the I Ching in my book, “Change Your Life With Feng Shui.”



The magic square is part of a mathematical formula developed to help us understand the universe and the forces that affect one's destiny. The magic square is said to have first appeared about 4,000 years ago. It was seen as dots on the back of a turtle as it emerged from the River Lo, and thus signifies the importance of turtle energy.

The magic square is a grid consisting of nine numbers arranged so that each side adds up to fifteen regardless of whether horizontal, vertical or diagonal rows are used. The way the numbers are arranged in this square holds the key to your best environments.

SUN 4	LI 9	KUN 2
CHEN 3	5	TUI 7
KEN 8	KAN 1	CHEN 6

Locations are lucky or unlucky according to your special Kua number. There are actually nine numbers in the eight-sided octagon, but since number five is the center, men and women with that number are assigned a different number because of five does not have a direction. Because five is an earth element and so are number two and eight. The Eight Kua number is assigned to women who are fives and men are assigned the Kua number two who are fives. The chart in the back of the book shows you clearly which category Kua numbers you belong in.

This chart contains your Kua number. (If you were born early in the year, please note that you may have to adjust your year of birth to determine your Kua number, as your birth date may fall before Chinese New Year. Chinese New Year begins at different times each year, always after the first New Moon in Aquarius somewhere between January 21st and Feb. 19th).

As you get further into Feng Shui you will need to know which two groups you belong in, West or East groups. When you begin to decorate your home with your best colors and good directions you need this information. Listed below are the two groups with their different directions, EAST or WEST.

**The EAST group includes these Kua numbers:**

- 3 East**
- 4 Southeast**
- 1 North**
- 9 South**

**WEST group consists of these Kua numbers:**

- 2 Southwest**
- 6 Northwest**
- 7 West**
- 8 Northeast\***

There are also five elements to consider: Metal, Wood, Fire Earth and Water. Each Kua number and direction also has an element. You will also find your element listed in the chart in the back of the book. It is a lot to remember at one time, but try to remember your Kua number and keep track as you read this book, because the information herein is specific to your Kua number, direction, group and element!

\*This is the only East direction that belongs to the West group.

YEAR	STARTS	ENDS	SIGN	Male Kua-Direction	Female Kua-Direction
1912	18-Feb-1912	5-Feb-1913	Water Rat	(color) 6 Northwest (Metal, White)	8 Northeast (Earth, Gold)
1913	6-Feb-1913	25-Jan-1914	Water Ox	6 Northwest (Metal, White)	9 South (Fire, Red)
1914	26-Jan-1914	13-Feb-1915	Wood Tiger	2 Southwest (Earth, Gold)	1 North (Water, Blue)
1915	14-Feb-1915	2-Feb-1916	Wood Rabbit	4 Southeast (East, Green)	2 Southwest (Earth, Gold)
1916	3-Feb-1916	22-Jan-1917	Fire Dragon	3 East (Wood, Green)	3 East (Wood, Green)
1917	23-Jan-1917	10-Feb-1918	Fire Snake	2 Southwest (Earth, Gold)	4 Southeast (Wood, Green)
1918	11-Feb-1918	31-Jan-1919	Earth Horse	1 North (Water, Blue)	8 Northeast (Earth, Gold)
1919	1-Feb-1919	19-Feb-1920	Earth Goat	9 South (Fire, Red)	6 Northwest (Metal, White)
1920	20-Feb-1920	7-Feb-1921	Metal Monkey	8 Northeast (Earth, Gold)	7 West (Metal, White)
1921	8-Feb-1921	27-Jan-1922	Metal Rooster	7 West (Metal, White)	8 Northeast (Earth,Gold)
1922	28-Jan-1922	15-Feb-1923	Water Dog	6 Northwest (Metal, White)	9 South (Fire, Red)
1923	16-Feb-1923	4-Feb-1924	Water Pig	2 Water (Earth, Gold)	1 North (Water, Blue)
1924	5-Feb-1924	24-Jan-1925	Wood Rat	4 Southeast (Earth, Gold)	2 Southwest (Earth, Gold)
1926	13-Feb-1926	1-Feb-1927	Fire Tiger	2 Southwest (Earth, Gold)	4 Southeast (Wood, Green)
1927	2-Feb-1927	22-Jan-1928	Fire Rabbit	1 North (Water, Blue)	8 Northeast (Earth, Gold)
1928	23-Jan-1928	9-Feb-1929	Earth Dragon	9 South (Fire, Red)	2 Southwest (Earth, Gold)
1929	10-Feb-1929	29-Jan-1930	Earth Snake	8 Northeast (Metal, White)	4 Southeast (Wood, Green)
1930	30-Jan-1920	16-Feb-1931	Metal Horse	8 Northeast (Earth, Gold)	7 West (Metal, White)
1931	17-Feb-1931	5-Feb-1932	Metal Sheep	6 Northwest (Metal, White)	9 South (Fire, Red)
1932	6-Feb-1932	25-Jan-1933	Water Monkey	2 Southwest (Earth, Gold)	1 North (Water, Blue)
1933	26-Jan-1933	13-Feb-1934	Water Rooster	4 Southeast (Wood,Green)	2 Southwest (Earth, Gold)
1934	14-Feb-1934	3-Feb-1935	Wood Dog	3 East (Wood, Green)	3 East (Wood, Green)
1935	4-Feb-1935	23-Jan-1936	Wood Pig	2 Southwest (Earth, Gold)	4 Southeast (Wood, Green)
1936	24-Jan-1936	10-Feb-1937	Fire Rat	1 North (Water, Blue)	8 Northeast (Metal, White)
1937	11-Feb-1937	30-Jan-1938	Fire Ox	9 South (Fire, Red)	6 Northwest (Metal, White)
1938	31-Jan-1938	18-Feb-1939	Earth Tiger	8 Northeast (Earth, Gold)	7 West (Metal, White)
1939	19-Feb-1939	7-Feb-1940	Earth Rabbit	7 West (Metal, White)	8 Northeast (Earth, Gold)
1940	8-Feb-1940	26-Jan-1941	Metal Dragon	6 Northwest (Metal, White)	9 South (Fire, Red)

YEAR	STARTS	ENDS	SIGN	Male Kua-Direction	Female Kua-Direction
1941	27-Jan-1941	14-Feb-1942	Metal Snake	2 Southwest (Earth, Gold)	1 North (Water, Blue)
1942	15-Feb-1942	4-Feb-1943	Water Horse	3 East (Wood, Green)	2 Southwest (Earth, Gold)
1943	5-Feb-1943	24-Jan-1944	Water Sheep	3 East (Wood, Green)	3 East (Wood, Green)
1944	25-Jan-1944	12-Feb-1945	Wood Monkey	2 Southwest (Earth, Gold)	4 Southeast (Wood, Green)
1945	13-Feb-1945	1-Feb-1946	Wood Rooster	1 North (Water, Blue)	8 Northeast (Earth, Gold)
1946	2-Feb-1946	21-Jan-1947	Fire Dog	9 South (Fire, Red)	6 Northwest (Metal, White)
1947	22-Jan-1947	9-Feb-1948	Fire Pig	8 Northeast (Earth, Gold)	7 West (Metal, White)
1948	10-Feb-1948	28-Jan-1949	Earth Rat	7 West (Metal, White)	8 Northeast (Earth, Gold)
1949	29-Jan-1949	16-Feb-1950	Earth Ox	6 Northwest (Metal, White)	9 South (Fire, Red)
1950	17-Feb-1950	5-Feb-1951	Metal Tiger	2 Southwest (Earth, Gold)	1 North (Water, Blue)
1951	6-Feb-1951	26-Jan-1952	Metal Rabbit	4 Southeast (Wood, Green)	2 Southwest (Earth, Gold)
1952	27-Jan-1952	13-Feb-1953	Water Dragon	3 East (Wood, Green)	3 East (Wood, Green)
1953	14-Feb-1953	2-Feb-1954	Water Snake	2 Southwest (Earth, Gold)	4 Southeast (Wood, Green)
1954	3-Feb-1954	23-Jan-1955	Wood Horse	1 North (Water, Blue)	8 Northeast (Earth, Gold)
1955	24-Jan-1955	11-Feb-1956	Wood Sheep	9 South (Fire, Red)	6 Northwest (Metal, White)
1956	12-Feb-1956	30-Jan-1957	Fire Monkey	8 Northeast (Earth, Gold)	7 West (Metal, White)
1957	31-Jan-1957	17-Feb-1958	Fire Rooster	7 West (Metal, White)	8 Northeast (Earth, Gold)
1958	18-Feb-1958	7-Feb-1959	Earth Dog	6 Northwest (Metal, White)	9 South (Fire, Red)
1959	8-Feb-1959	Jan 27, 1960	Earth Pig	2 Southwest (Earth, Gold)	1 North (Water, Blue)
1960	28-Jan-1960	14-Feb-1961	Metal Rat	4 Southeast (Wood, Green)	2 Southwest (Earth, Gold)
1961	15-Feb-1961	4-Feb-1962	Metal Ox	3 East (Wood, Green)	3 East (Wood, Green)
1962	5-Feb-1962	24-Jan-1963	Water Tiger	2 Southwest (Earth, Gold)	4 Southeast (Wood, Green)
1963	25-Jan-1963	12-Feb-1964	Water Rabbit	1 North (Water, Blue)	8 Northeast (Earth, Gold)
1964	13-Feb-1964	1-Feb-1965	Wood Dragon	9 South (Fire, Red)	6 Northwest (Metal, White)
1965	2-Feb-1965	20-Jan-1966	Wood Snake	8 Northeast (Earth, Gold)	7 West (Metal, White)
1966	21-Jan-1966	8-Feb-1967	Fire Horse	7 West (Metal, White)	8 Northeast (Earth, Gold)
1967	9-Feb-1967	29-Jan-1968	Fire Sheep	6 Northwest (Metal, White)	9 South (Fire, Red)
1968	30-Jan-1968	16-Feb-1969	Earth Monkey	2 Southwest (Earth, Gold)	1 North (Water, Blue)

YEAR	STARTS	ENDS	SIGN	Male Kua-Direction	Female Kua-Direction
1969	17-Feb-1969	5-Feb-1970	Earth Rooster	4 Southeast (Wood, East)	2 Southwest (Earth, West)
1970	6-Feb-1970	26-Jan-1971	Metal Dog	3 East (Wood, Green)	3 East (Wood, Green)
1971	27-Jan-1971	15-Jan-1972	Metal Pig	7 West (Metal, White)	8 Northeast (Earth, Gold)
1972	16-Jan-1972	2-Feb-1973	Water Rat	1 North (Water, Blue)	8 Northeast (Earth, Gold)
1973	3-Feb-1973	22-Jan-1974	Water Ox	9 South (Fire, Red)	6 Northwest (Metal, White)
1974	23-Jan-1974	10-Feb-1975	Wood Tiger	8 Northeast (Earth, Gold)	7 West (Metal, White)
1975	11-Feb-1975	30-Jan-1976	Wood Rabbit	7 West (Metal, White)	8 Northeast (Earth, Gold)
1976	31-Jan-1976	17-Feb-1977	Fire Dragon	6 Northwest (Metal, White)	9 South (Fire, Red)
1977	18-Feb-1977	6-Feb-1978	Fire Snake	2 Southwest (Earth, Gold)	1 North (Water, Blue)
1978	7-Feb-1978	27-Jan-1979	Earth Horse	4 Southeast (Wood, Green)	2 Southwest (Earth, Gold)
1979	28-Jan-1979	15-Feb-1980	Earth Sheep	3 East (Wood, Green)	3 East (Wood, Green)
1980	16-Feb-1980	4-Feb-1981	Monkey Metal	2 Southwest (Earth, Gold)	4 Southeast (Wood, Green)
1981	5-Feb-1981	24-Jan-1982	Metal Rooster	1 North (Water, Blue)	8 Northeast (Earth, Gold)
1982	25-Jan-1982	12-Feb-1983	Water Dog	9 South (Fire, Red)	6 Northwest (Metal, White)
1983	13-Feb-1983	1-Feb-1984	Metal Pig	8 Northeast (Earth, Gold)	7 West (Metal, White)
1984	2-Feb-1984	19-Feb-1985	Wood Rat	7 West (Metal, White)	8 Northeast (Earth, Gold)
1985	20-Feb-1985	8-Feb-1986	Wood Ox	6 Northwest (Metal, White)	9 South (Fire, Red)
1986	9-Feb-1986	28-Jan-1987	Fire Tiger	2 Southwest (Earth, Gold)	1 North (Water, Blue)
1987	29-Jan-1987	16-Feb-1988	Fire Rabbit	4 Southeast (Wood, Green)	2 Southwest (Earth, Gold)
1988	17-Feb-1988	5-Feb-1989	Earth Dragon	3 East (Wood, Green)	3 East (Wood, Green)
1989	6-Feb-1989	26-Jan-1990	Earth Snake	2 Southwest (Earth, Gold)	4 Southeast (Wood, Green)
1990	27-Jan-1990	14-Feb-1991	Metal Horse	1 North (Water, Blue)	8 Northeast (Earth, Gold)
1991	15-Feb-1991	3-Feb-1992	Metal Sheep	9 South (Fire, Red)	6 Northwest (Metal, White)
1992	4-Feb-1992	22-Jan-1993	Water Monkey	8 Northwest (Metal, White)	7 West (Metal, White)
1993	23-Jan-1993	9-Feb-1994	Water Rooster	7 West (Metal, White)	8 Northeast (Earth, Gold)
1994	10-Feb-1994	30-Jan-1995	Wood Dog	9 South (Fire, Red)	8 Northeast (Earth, Gold)
1995	31-Jan-1995	18-Feb-1996	Wood Pig	2 Southwest (Earth, Gold)	1 North (Water, Blue)
1996	19-Feb-1996	7-Feb-1997	Fire Rat	4 Southeast (Wood, Green)	2 Southwest (Earth, Gold)

YEAR	STARTS	ENDS	SIGN	Male Kua-Direction	Female Kua-Direction
1997	8-Feb-1997	27-Jan-1998	Fire Ox	3 East (Wood, Green)	3 East (Wood, Green)
1998	28-Jan-1998	15-Feb-1999	Earth Tiger	2 Southwest (Earth, Gold)	3 East (Wood, Green)
1999	16-Feb-1999	4-Feb-2000	Eartj Rabbit	1 North (Water, Blue)	8 Northeast (Earth, Gold)
2000	5-Feb-2000	23-Jan-2001	Metal Dragon	1 North (Water, Blue)	8 Northeast (Earth, Gold)
2001	24-Jan-2001	11-Feb-2002	Metal Snake	9 South (Fire, Red)	6 Northwest (Metal, White)
2002	12-Feb-2002	31-Jan-2003	Water Horse	8 Northeast (Earth, Gold)	7 West (Metal, White)
2003	1-Feb-2003	21-Jan-2003	Water Sheep	7 West (Metal, White)	8 Northeast (Earth, Gold)
2004	22-Jan-2004	8-Feb-2005	Wood Monkey	6 Northwest (Metal, White)	9 South (Fire, Red)
2005	9-Feb-2005	28-Jan-2006	Wood Rooster	2 Southwest (Earth, Gold)	1 North (Water, Blue)
2006	29-Jan-2006	17-Feb-2007	Fire Dog	4 Southeast (Wood, Green)	2 Southwest (Earth, Gold)
2007	18-Feb-2008	6-Feb-2008	Fire Piq	3 East (Wood, Green)	3 East (Wood, Green)

# Enjoy yourself while improving your life with feng shui

I wish you abundant good luck and much success in using this little book.

Have fun with your journey, and don't forget to periodically evaluate your progress.

If you have any questions, I will be happy to answer them from my website:

[www.aquarianzone.com](http://www.aquarianzone.com)