

BAZANTNICE (PHEASANTS FIELD)

INTRODUCTION

The *idée fixe* for the proposal for Bazantnice is the pheasant, as symbol of the natural and lyrical. As such, the gardens are dedicated to the pheasant.

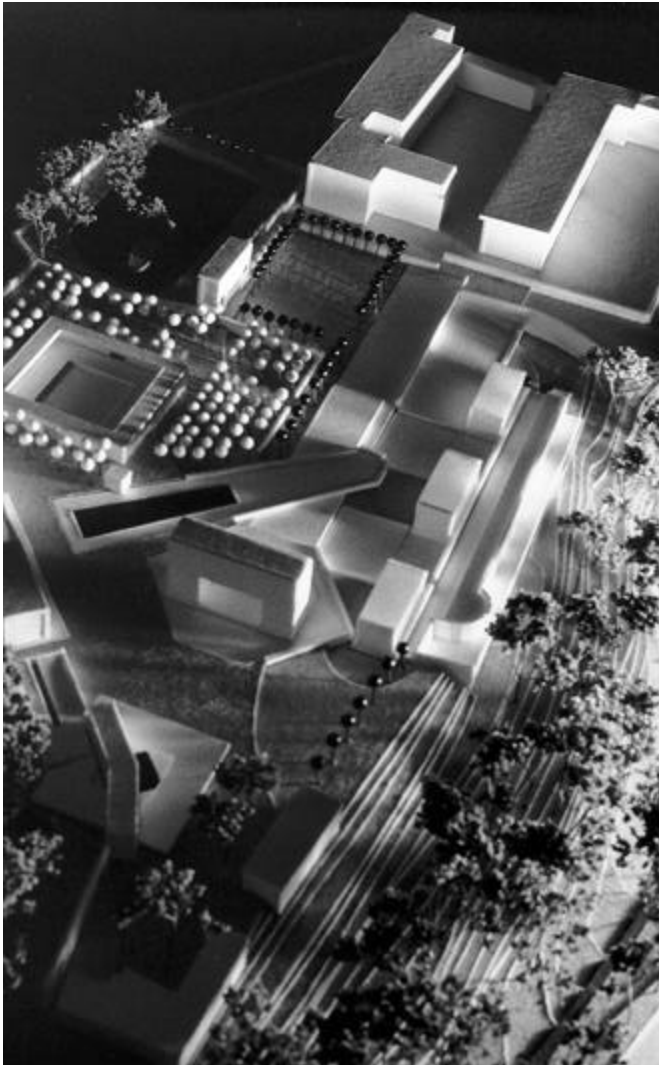

MODEL IMAGE

The so-called moat (there was never any water in it) is to the right. The Royal Gardens are straight on, beyond the frame of the image but on axis with the Proscenium (Arch). To the top left, and in the shadows, is the Pheasants Refuge, a Renaissance-era fish pond. The diagonal structure, middle left to lower center, is the extant configuration of Renaissance, Baroque and Neoclassical building fabric. The form perpendicular to the diagonal is Plecnik's terrace. It, in turn, points to St. Vit's, at Prague Castle. The Riding School, now Writing School, is the building volume to the top left. The hypertext pavilions are the translucent boxes at the edge of the Hart's moat.

(chipboard, museum board, push pins, vellum, yarrow stalks / 3200-ASA print)

PRECIS

The overall composition of the gardens is based on a close look at the baroque gardens of Prague and the gardens of Plecnik at Prague Castle. Both have influenced the architectonic form of the proposal. **PLECNIK'S TERRACE (E)**, a central part of the program, is an homage to Plecnik (in the form of a terrace that, in plan, resembles a fallen obelisk).

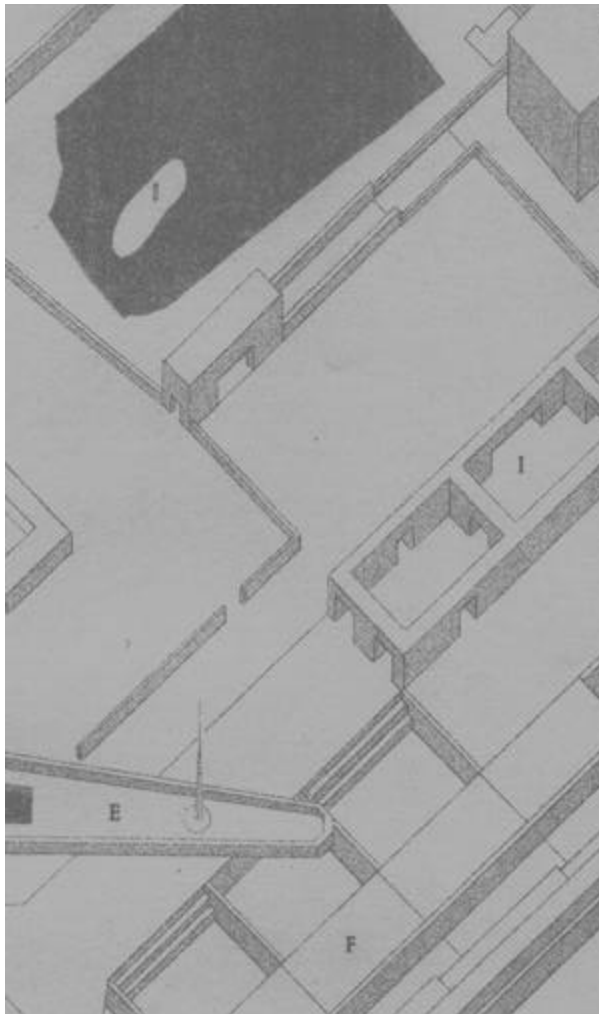

The Riding School is to become a **WRITING SCHOOL**, plus various utilitarian functions, as a means of making Bazantnice a cultural garden/landscape. The Writing School is to be established in association with Charles University (or another school) to facilitate the selection of fellows and junior fellows to reside for one year and six months (respectively) in Prague and work on the premises. The School is to be an institution for the advancement of cultural and critical studies: philosophy of history; architectural criticism; literary theory and practice; theatre

arts; etc. The work is to be carried out in a digital mode (on computer workstations). The texts of the School will be

presented in the **HYPertext PAVILIONS (F)** as works in progress.

Image (above) - Inner, high-architectonic portion of the gardens (ink on mylar, Letratype, w/ Letratone / xeroxed)

The Hypertext Pavilions will also serve to display multi-media programming as a fully-wired facility. Besides its links to the Writing School, the Pavilions will have computerized audio and video links to other cultural facilities in the Czech Republic. The Hypertext Pavilions are to be administered by the Writing School.

The **BLACK-BOX THEATRE** is to be associated with the Writing School, and it is intended to support an experimental theatre company. As it is so small, it is not intended for public performances. It is to be used for developing avant-garde theatre.

The **INNER GARDENS (I)** -- see axonometric -- are conceptualized as a series of pavilions, garden rooms, terraces and groves. The orchard is mostly saved with the implantation of an enclosed (cloistered) garden based on the geometry of the cube, **CUBUS**. This garden is to be both a place for reflection and a means of studying the geometry of the cube. *Pace* Proclus: "Geometry is the vestibule of philosophy."

The adjacent fish pond is to become the center of the **PHEASANTS REFUGE**. It is to be enclosed by a fence or wall and to be viewed from a distance only. A gate-house has been provided as a viewing station and to formalize the enclosure.

This area is to be made a sanctuary for the pheasant (not a prison). It is expected that the pheasant will wander beyond its boundaries. A keeper may be headquartered in the Hunter's Lodge or the upper floor of the gate-house. The enclosed area is to grow wildly, with pheasant's-eye narcissus freely planted in the long-grass meadow surrounding the pond. Willow trees (Salix) are to be planted to the north and east of the pond. The island is to have a single willow and an inscribed column with one word, "Bazantnice".

On the central axis from the Writing School courtyard is a series of **HEDGED GARDENS (I)** leading to the new Plecnik Terrace. These garden rooms will be enclosed in high hedges clipped to form dense walls, gates and windows. Within each room a variety of views into other parts of the garden is possible. The long view, however, along the east-west axis, is blocked by the configuration of the hedge and its openings. The rooms will support places to sit and minimalist plantings of horticultural interest. The height of the hedges will shade the rooms for the best part of the day from direct sunlight. Direct light will, however, penetrate through the various openings in the hedge as the sun progresses from east to west.

To the west of the hedged gardens, and the new Plecnik Terrace, on the main axis, is the proposed **PROSCENIUM THEATRE/STAGE**. This pavilion is intended to provide flexible performance space with viewing from either side. The height of the pavilion allows for the storage of stage properties and screens. To the east of the stage is a small orchestra pit.

CHIASMUS is immediately to the west of the Proscenium Theatre. It is incorporated into the Orchid Houses and utilizes the Renaissance perimeter wall. Chiasmus is a well. It is meant for re-charging the water in the garden. It also is proposed for pure dramatic effect. It is to be kinetic: Water is to rush into its upper basin and fall ten meters to the lower pool. Surrounding Chiasmus is a terrace that links up with the Orchid Houses and the passage through to the west side of the Renaissance diagonal wall. It is also possible that Chiasmus might generate mist for the Orchid Houses.

The former offices of the head gardener, at the Renaissance Gate, are to be converted to a small **RESTAURANT** and **CAFE** (with indoor and outdoor service).

The buildings formerly known as 188a, b, and c are to remain **GUEST HOUSES** for fellows of the Writing School and official guests of the Castle Administration.

CERNIN FIELD is virtually a natural amphitheatre, and is, as such, to be further enhanced for this purpose. To the north of Cernin Field, and to the south of the existing residential block, a swimming pool is suggested (with conversion to skating in winter). The residential block should remain a mix of offices (studios) and residences. Opposite, to the east of U Brusnice, an additional recreational space is designated as "multi-purpose recreational turf". It is expected that this would become a place for soccer and other informal athletic events.

The **BASTION**, to the west, is to be remain a passive park,

albeit a linear park, with the parapet path as a continuous viewing station of Hradcany. Trees are to be added to the west of the parapet wall to enhance the park-like quality.



NOTES ON THE DRAWINGS

Discrepancies between the drawings are intentional. They are a result of each drawing being used as a design tool. The axonometric is meant to represent the full architectonic character of Bazantnice in an abstract way. This drawing is developed as a tool for seeing the formal logic, not the details of the site plan. The vertical dimensions have been exaggerated slightly to emphasize the volumetric logic.

Image (left) - Fragments of the site
(photo-montage)



The two site plans (site plan and area plan) show different levels of resolution. The area plan is meant to show the urban context and emphasize the green spaces. Existing conditions have been saved, in the site plan and area plan, for clearer understanding of the proposed changes.

The principal question raised by the site plan versus the area plan is what relationship does the main garden axis and the Hypertext Pavilions have to the Energozentrum building. The site plan suggests that the Hedged Gardens might overlap the roof of the Energozentrum building, shortening the latter's width. This would, in turn, increase the dimensions of the areas to the north of the Hedged Gardens. This requires that the load of the Hedged Gardens (over the Energozentrum roof) be no more than 500kg per

square meter, or that a cantilever support the extension over the roof.

The relationship of the Hypertext Pavilions to the Energozentrum building and the Masaryk Overlook is very complex. The Hypertext Pavilions would be below grade, for the most part, opening on to the Hart's Moat. They would, in fact, be constructed such that the structure supports (incorporates) the Masaryk Overlook and Walk. The third, eastern-most pavilion would rest against the south wall of the Energozentrum building, shortening this facade. Existing windows of the latter building would be lost. The Hypertext Pavilions will be primarily glass and steel construction. They are intended to be contiguous by virtue of the underground passages between each of the pavilions and the through passage, below the Masaryk Overlook and Walk, to the proposed terrace at the edge of the Hart's Moat.